

Single-phase transformers with double chamber bobbin and alternately stacked lamination are produced with electrical output power and dimensions according to table below.

Voltage transfer 1-1000 V in any combination. Covering IP20 to IP54 according to transformer type. It could be protected by thermal switch.

Type:

VV - input and output by cord

VS - input cord, output terminal block

SS - input and output terminal block (like WAGO, IP20)

HA - for halogen lamp unit, class III.

Other variations are available upon discussion with the engineering department.

VV

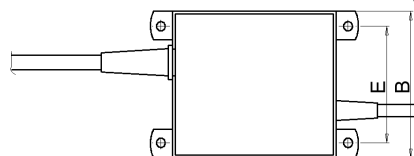

VS

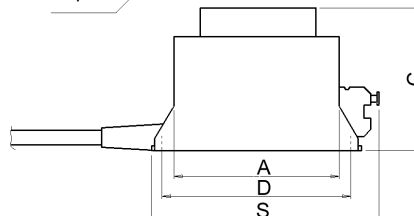
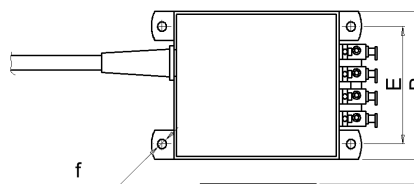
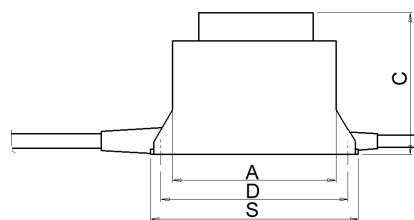

Type	Style	Dimensions [mm]							Rated output VA	Weight (informative) Kg
		A	B	C	D	E	S	f		
E 2021 / 2	VV	65	55	47	72,5	43,5	82	4,2	12	0,59
	VS	65	55	47	72,5	43,5	100	4,2		
E 2025 / 2	VV	65	55	51,5	72,5	43,5	82	4,2	20	0,68
	VS	65	55	51,5	72,5	43,5	100	4,2		
E 2030 / 2	VV	65	55	56,5	72,5	43,5	82	4,2	30	0,75
	VS	65	55	56,5	72,5	43,5	100	4,2		
E 2525 / 2	VV	79	66	58	90	52,5	100	4,2	32	1,14
	VS	79	66	58	90	52,5	110	4,2		
E 2532 / 2	VV	79	66	64	90	52,5	100	4,2	50	1,40
	VS	79	66	64	90	52,5	110	4,2		
E 2540 / 2	VV	79	66	73	90	52,5	100	4,2	80	1,96
	VS	79	66	73	90	52,5	110	4,2		
E 3236 / 2	VV	101	85	75	115	70	130	6,3	100	2,80
	VS	101	85	75	115	70	135	6,3		
E 3245 / 2	VV	101	85	85	115	70	130	6,3	125	3,25
	VS	101	85	85	115	70	135	6,3		
E 3260 / 2	VV	101	85	99	115	70	130	6,3	160	4,40
	VS	101	85	99	115	70	135	6,3		
E 4050 / 2	VV	125	105	110	150,5	85	177	8,4	200	6,00
	VS	125	105	110	150,5	85	195	8,4		
E 4070 / 2	VV	125	105	130	150,5	85	177	8,4	300	7,65
	VS	125	105	130	150,5	85	195	8,4		